

# Absolute Hall Effect Encoders

SSI Output



## EHE111

Size 11 mm  
Hall Effect

Cable outlet with 6 wires  
KZ 0504 AWG 26 L : 350 mm

### Electrical Specifications

Measurement range	360°
Supply voltage	+5 ± 0,25 Vdc
Maximum supply current	< 13 mA
Power-on settlement time	< 0,150 s
Resolution (Factory programmed)	12 to 16 bits
Non-linearity	± 0,75°
Temperature coefficient	< 50 ppm/°C
Hysteresis (Factory programmed)	0,02° min
Sample rate	10 KHz
Input/output delay (factory programmed)	0,6 ms < t <sub>d</sub> < 1,8 ms
Insulation resistance	≥ 1000 MΩ - 500 Vdc
Dielectric withstanding voltage	750 Veff (50 Hz 1 min)

### Mechanical Specifications

Mechanical angle	360°
Operating torque	≤ 20 cN.cm
Max rotating speed	6000 rpm
Weight	< 25 gr
Mounting	servo
Size of housing	From 08 to 30 (EHE108 to EHE130)

For any further information, please contact our sales department :



1 La Chaudure - 23190 Champagnat - France  
Tel : 33(0)5 55 67 70 00 Fax : 33(0)5 55 67 68 59  
contact@codechamp.fr www.codechamp.fr

**EHE111**  
Absolute Hall Effect Encoders - SSI Output

# Absolute Hall Effect Encoders EHE111

SSI Output

## Drawing

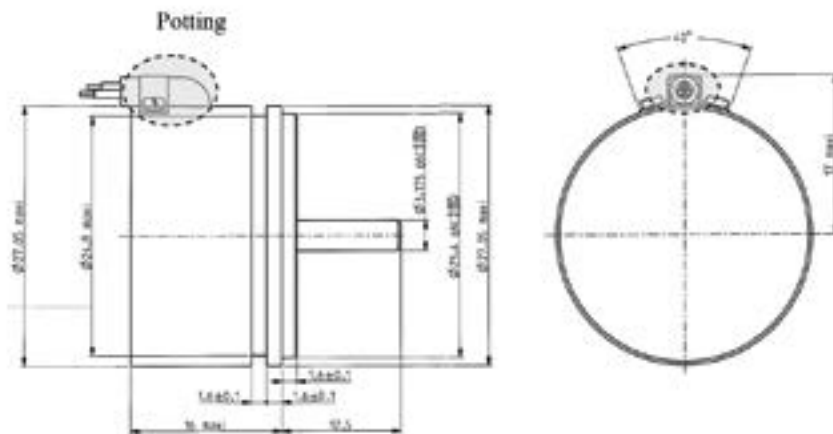

## Environment

Protection class	IP54
Life contactless sensor	Essentially infinite > 350 millions cycles
Operating & storage temperatures	-55°C to +125°C
Vibration IEC 68-2-6	20 g max at 50 to 2000 Hz
Shock IEC 68-2-27	50 g 11 ms 1/2 sinus
EMC immunity BS EN 61000-4-3	100 V/m 80MHZ to 1 GHz
Max permitted axial shaft load	5 N
Max permitted radial shaft load	5 N

## Options

Output direction for increasing output	Clockwise or anticlockwise shaft rotation (Factory programmed)
Length of wires	L : 1 m
OEM options	On request
Redundancy	On request
Non linearity with external EEPROM	± 0,25°
Temperatures peaks	- 70°C & + 180 °C

## SSI Output

Data output	RS 422A
Data input	Clock (RS 422A)
Output code	Binary

## Timing diagram

Clock H	1 KHz to 2 MHz
Data SS (Factory programmed) + Parity	12 to 16 bits

